

RT. HON. HERB GRAY PARKWAY TEMPORARY SINGLE LANING OF E.C ROW EXPRESSWAY MALDEN ROAD TO MATCHETTE ROAD

Bridge rehabilitation work on the Matchette Road and the Malden Road overpasses on E.C. Row Expressway requires the closure of one lane in each direction through the work zone. The closures are as follows: one lane on the **westbound lanes** of E.C. Row Expressway will be closed from east of the Malden Road overpass to west of the Matchette Road overpass; one lane of the **eastbound lanes** will be closed east and west of the Matchette Road overpass only. This work is anticipated to start the week of September 14, 2015 and last approximately 11 weeks.

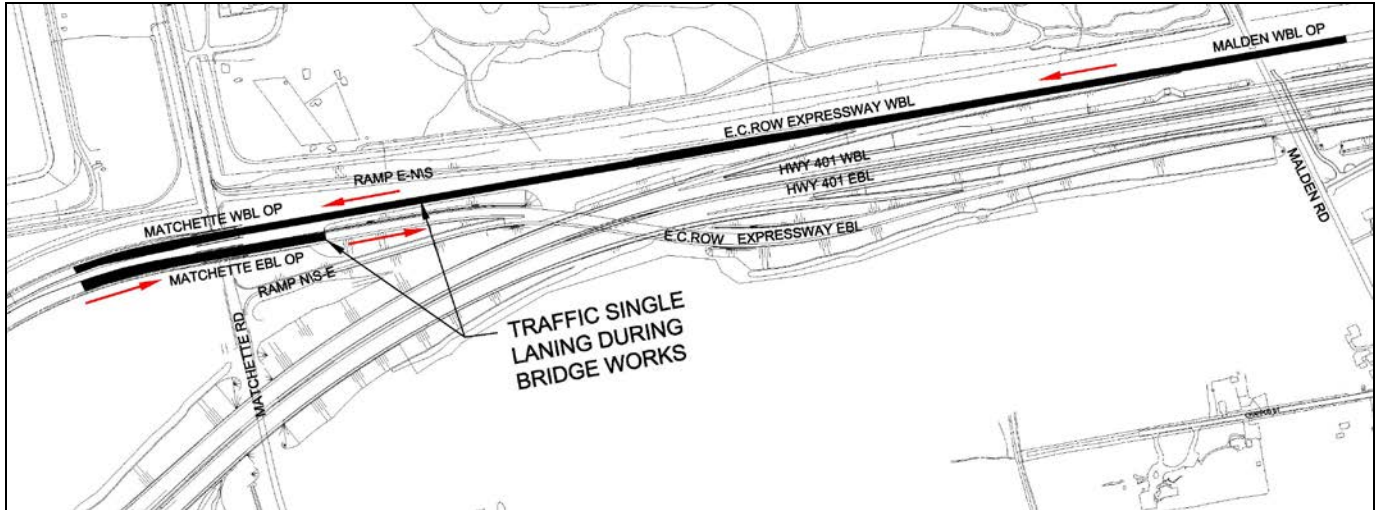

We appreciate your cooperation during this time. All closures are scheduled pending weather conditions. Please drive carefully through Parkway construction zones and follow all traffic signage. Visit our project web site (www.hgparkway.ca) or follow us on Twitter (@hgparkway) for any information regarding road closures. Should you have questions or concerns please contact the Windsor Essex Mobility Group Public Liaison Office at 1-877-937-5929 or via e-mail at hgp-plo@wemg.ca.

