

## Highway 3 reconstruction—Grand Marais Road West to Labelle Street

A portion of Highway 3 from Grand Marais Road West to Labelle Street will be closed for approximately **four months** beginning **Friday, July 3, 2015**, at 7:00 pm. The temporary closure is required for the construction of the new permanent section of Highway 3 and the new intersection across the Labelle Tunnel.

The closure will be conducted in three stages with different lane restrictions and closures in place. During this work, Highway 3 between Grand Marais Road West and Labelle Street will be **FULLY CLOSED**. Traffic accessing Highway 3 westbound between Cabana Road West/Todd Lane and Labelle Street will be detoured onto Highway 401 westbound via the on-ramp just west of Cabana Road West. For traffic in the Pulford Street area, the designated detour route is Pulford Street, to California Avenue, to Norfolk Street to Dominion Boulevard. Either E.C. Row Expressway or Cabana Road West to the Highway 401 on-ramp will provide access to Highway 3 west of Labelle Street. Westbound traffic from Highway 401 will rejoin Highway 3 at the "Highway 3/Huron Church Road" off-ramp. Traffic from Grand Marais Road West may access Highway 3 westbound west of Labelle Street via Dominion Boulevard to E.C. Row Expressway or Cabana Road West at the Highway 401 on-ramp. The attached maps outline the detour route and traffic staging during construction.

### Traffic staging for Grand Marais Road West and Labelle Street during closure of Highway 3

**Stage 1** will begin July 3 and last approximately six weeks (see below far left diagram)

- Right turns FROM Grand Marais Road West TO Highway 3 westbound will not be allowed
- Left turns FROM Highway 3 eastbound TO Grand Marais Road West are permitted
- Left turns FROM Grand Marais Road West TO Highway 3 eastbound are permitted
- Right turns FROM Labelle Street TO Highway 3 westbound are permitted

**Stage 2** will begin immediately following Stage 1 and last approximately three weeks (see below middle diagram)

- Traffic configuration at Grand Marais Road West from Stage 1 continues
- Labelle Street at Highway 3 completely closed

**Stage 3** will begin immediately following Stage 2 and last approximately six weeks (see below right diagram)

- Traffic configuration at Grand Marais Road West from Stages 1 and 2 continues
- Right turns FROM Labelle Street TO Highway 3 westbound are permitted
- Right turns FROM Highway 401 westbound on-ramp at Huron Church Road TO Labelle Street are permitted

Once this work is complete, crews will move to complete the intersection over the Labelle Tunnel to reconnect Bethlehem Avenue with Labelle Street across the below-grade Highway 401 portion of the Parkway. The current traffic configuration of right-in and right-out at Bethlehem Avenue and Highway 3 eastbound will continue until approximately October 2015. We apologize for the inconvenience.

If you plan to travel through the corridor, visit the What's Happening section or the interactive map on the project website or check out our Twitter feed before you head out to find the latest traffic information. If the public has any concerns regarding this construction staging, or other aspects of construction, please contact or visit the Public Liaison Office at 1-877-937-5929, 2187 Huron Church Road Suite 340, or [hgp-plo@wemg.ca](mailto:hgp-plo@wemg.ca).

Please visit [www.hgparkway.ca](http://www.hgparkway.ca) to learn more about the Rt. Hon. Herb Gray Parkway. Updates are posted on Twitter ([www.twitter.com/hgparkway](http://www.twitter.com/hgparkway)) and Facebook ([www.facebook.com/hgparkway](http://www.facebook.com/hgparkway)) and photos and videos are posted on Flickr ([www.flickr.com/hgparkway](http://www.flickr.com/hgparkway)) and YouTube ([www.youtube.com/hgparkway](http://www.youtube.com/hgparkway)).

# Detour and staging for Highway 3 reconstruction

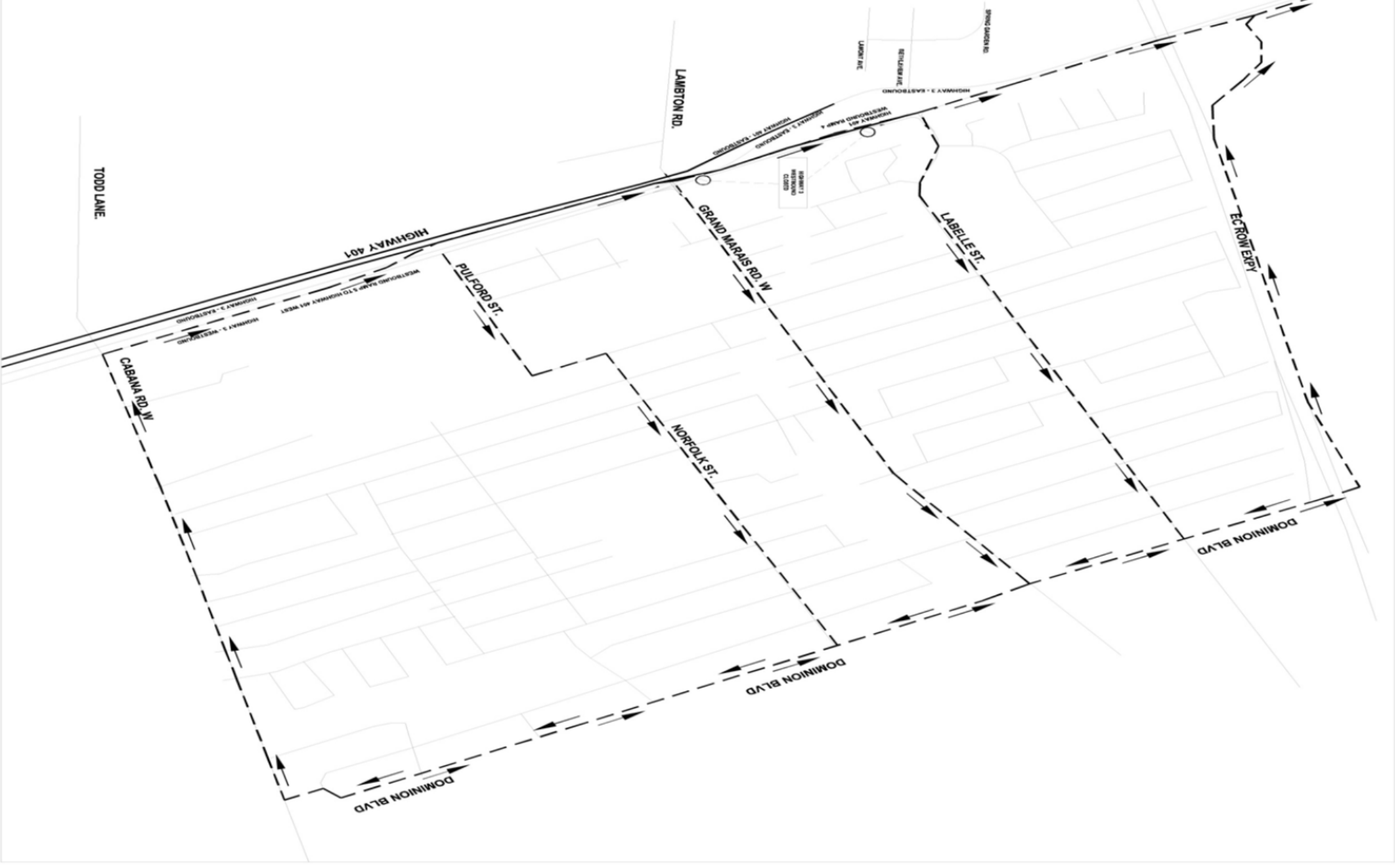

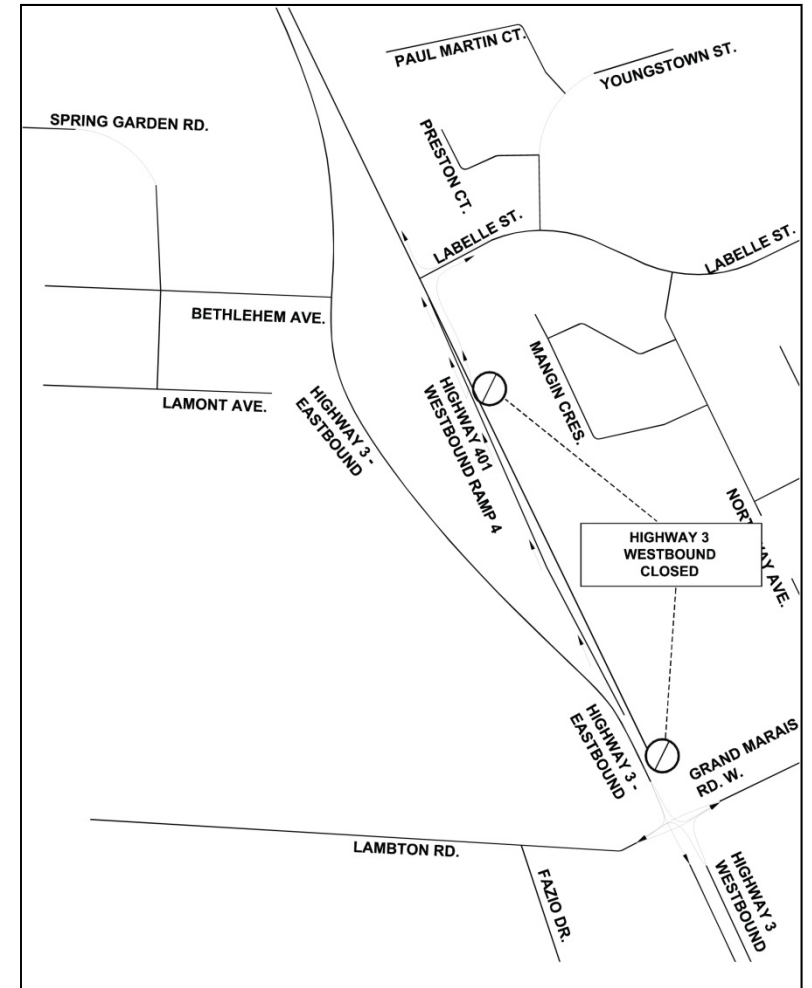
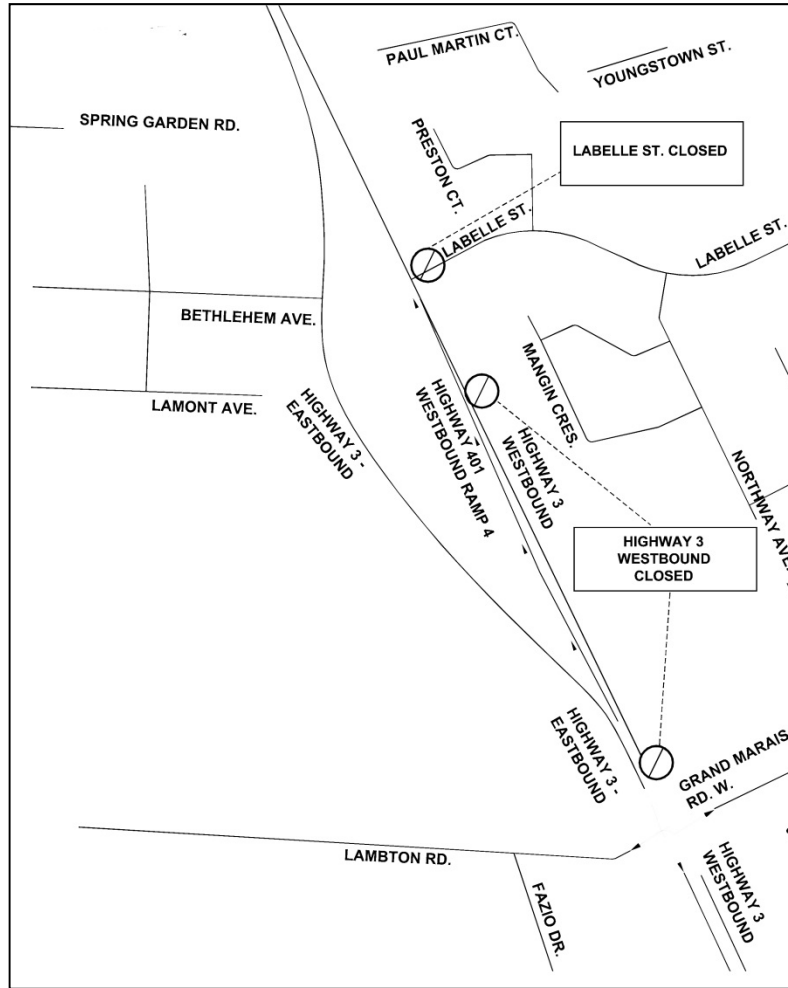
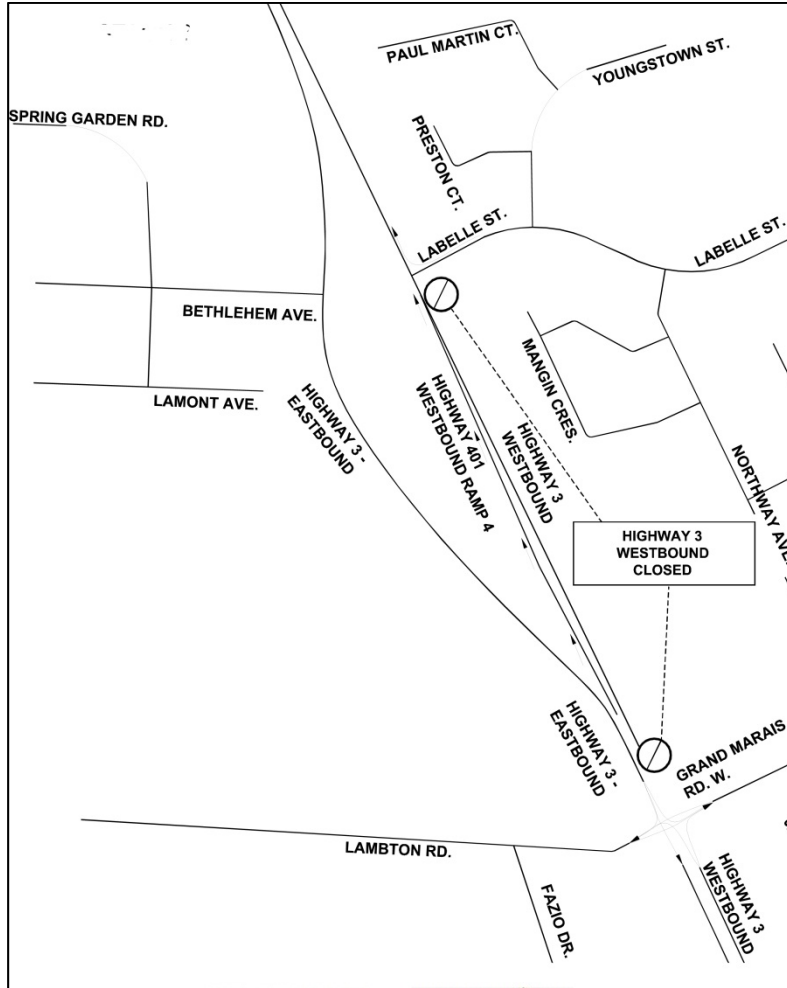

**Stage 1** will begin July 3 and last approximately six weeks

- Right turns FROM Grand Marais Road West TO Highway 3 westbound will not be allowed
- Left turns FROM Highway 3 eastbound TO Grand Marais Road West are permitted
- Left turns FROM Grand Marais Road West TO Highway 3 eastbound are permitted
- Right turns FROM Labelle Street TO Highway 3 westbound are permitted

**Stage 2** will begin immediately following Stage 1 and last approximately three weeks

- Traffic configuration at Grand Marais Road West from Stage 1 continues
- Labelle Street at Highway 3 completely closed

**Stage 3** will begin immediately following Stage 2 and last approximately six weeks

- Traffic configuration at Grand Marais Road West from Stages 1 and 2 continues
- Right turns FROM Labelle Street TO Highway 3 westbound are permitted
- Right turns FROM Highway 401 westbound on-ramp at Huron Church Road TO Labelle Street are permitted